

SHIP-FUELER «PILDNE S-1000»

1. FUNCTION & TYPE OF SHIP

- 1.1. Ship-fueler designed to transport and direct bunkering fleet of diesel fuel.
- 1.2. Steel ship with one-deck and twin propellers; with eight (8) cargo tanks, double bottom, inturned welts; with longitudinal bulkhead in cargo tanks zones; with engine room and twin-decks superstructure in stern zone of ship and pump room in bow zone; with ten (10) athwart bulkheads and with maneuvering propulsion device in bow of ship.

2. CLASS OF SHIP

According to Lloyd's Register of Shipping: **LSR +100A1 IceClass 1C UMS Double Hull Oil Tanker, ESP +LMC**

3. GENERAL ARRAGEMENT

3.1. Dimensions & Capability

L, m	56,0
B, m	12,4
D, m	5,5
d (cargo mark)	4,0
(sea water $\gamma=1,025 \text{ t/m}^3$)	
Burden, t (benzene & diesel fuel)	1000
Speed, knots	8,5
Crew	8
Power of propulsion engine, kWt	1 x 600
Distance from home port (max), mile	600
V cargo tanks, m^3	1200
V fuel tanks, m^3	50

3.2. Area of operation

Inland waters of Russian Federation and sea with limitation of navigation according to class.
+ Persian Gulf (Arabian Sea), Black Sea, Red Sea & Mediterranean Sea.

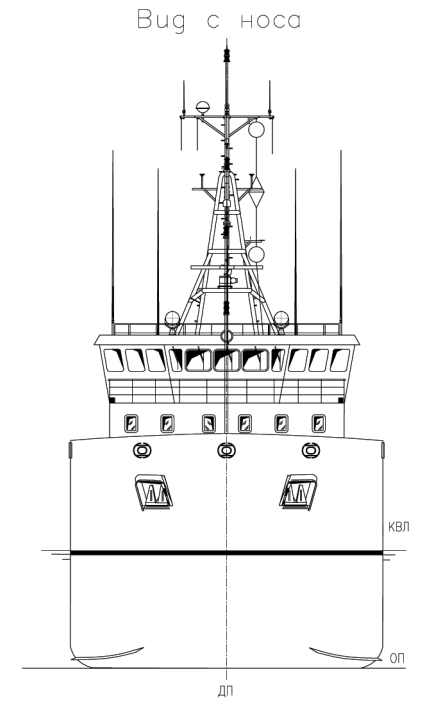
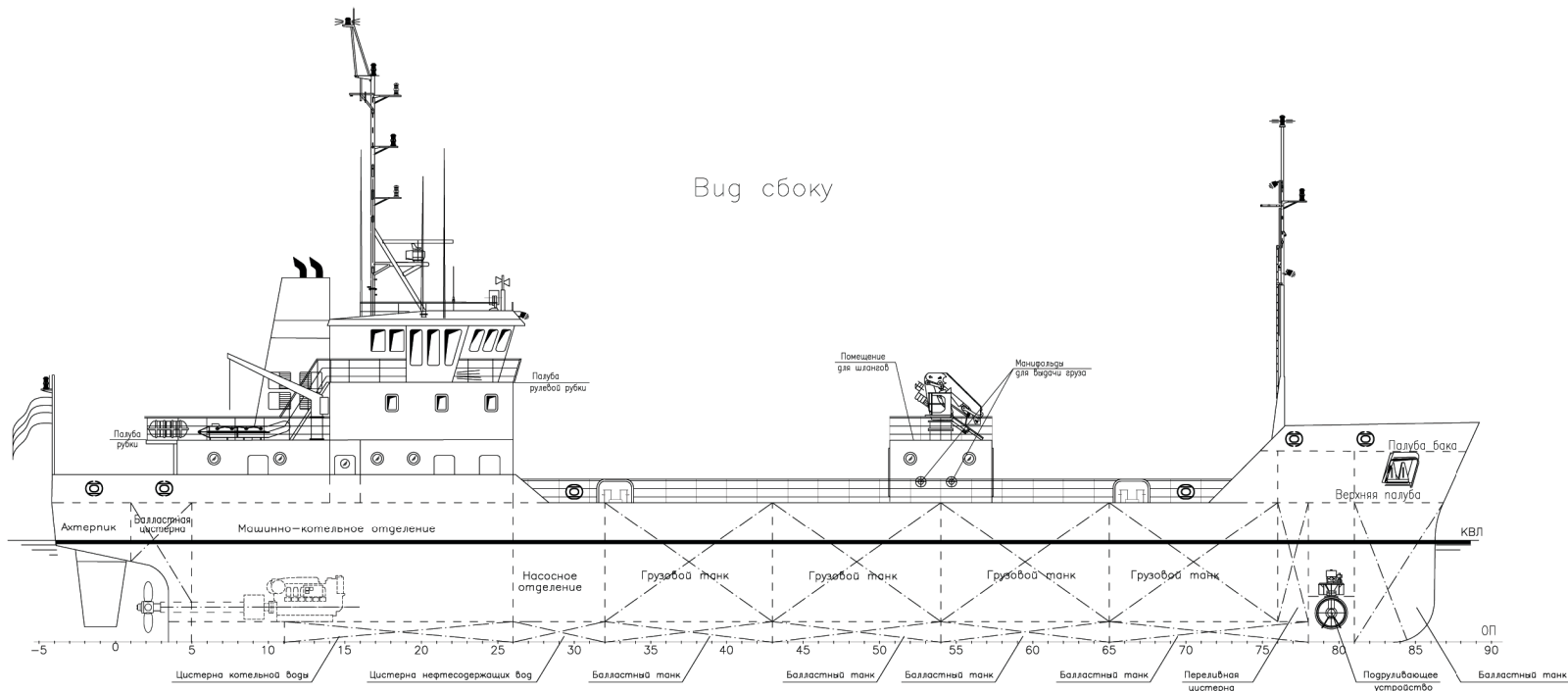

Палуба рулевой рубки

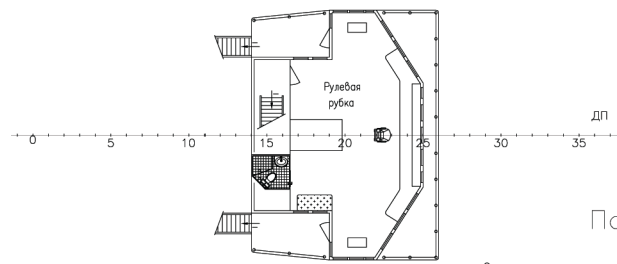

Палуба рубки и бака

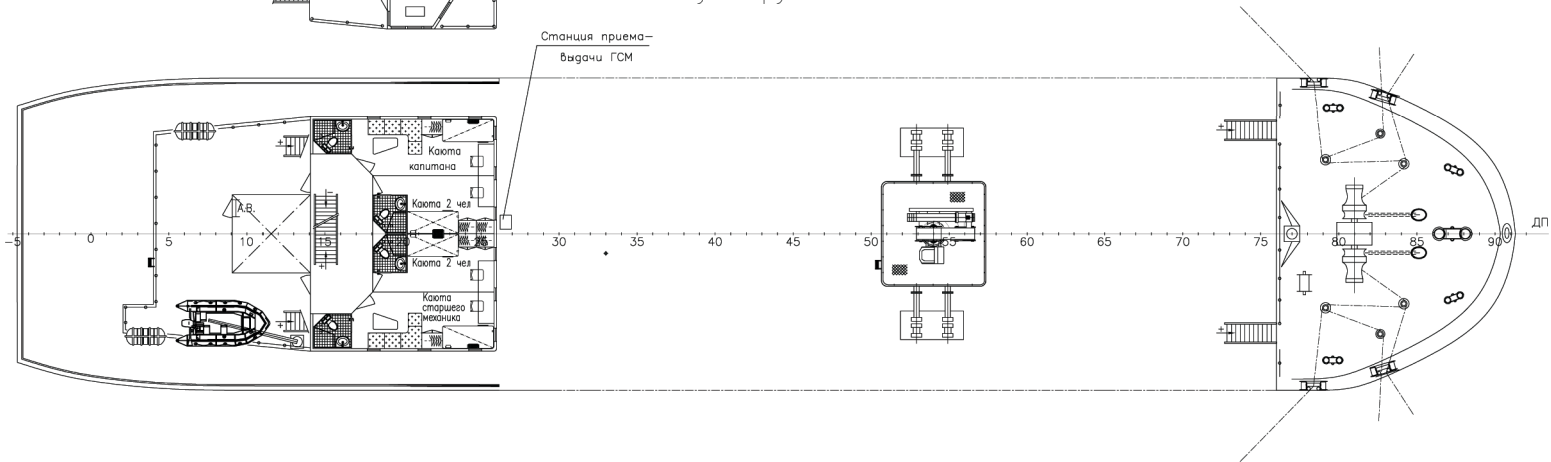

ГЛАВНЫЕ РАЗМЕРЕНИЯ

Класс	LRS +100A1 Ice Class 1C UMS Double Hull Oil Tanker ESP+LMC
Длина наибольшая	ок. 56,0 м
Ширина по корпусу (макс.)	ок. 12,4 м
Высота борта на миделе	ок. 5,5 м
Осадка по грузовой марке	ок. 4,0 м
Грузоподъемность	ок. 1000 т
Скорость	ок. 8,5 уз.
Экипаж	8
Мощность в/двигателя	ок. 600 кВт
Дальность плавания	600 миль
Объем грузовых танков	ок. 1200 м ³
Объем топливных цистерн ЭУ	ок. 50 м ³